



PLAZA AT CHERRY HILL

2100 ROUTE 38, CHERRY HILL, NJ 08002



RETHINK. RECREATE. REDEVELOP.



CAMDEN COUNTY'S DESTINATION FOR EVERYDAY SHOPPING

The Plaza at Cherry Hill is a centrally located power center in the heart of Cherry Hill, NJ with convenient access to and visibility from Route 38. The property serves Cherry Hill, Moorestown, Marlton and Pennsauken. This major employment hub is home to key employers including Subaru of America, Campbell's Soup, TD Bank and Lockheed Martin. The center is anchored by national brands such as Esporta Fitness, Raymour & Flanigan, Total Wine & More and Aldi.

Plaza at Cherry Hill

2100 Route 38, Cherry Hill, NJ 08002



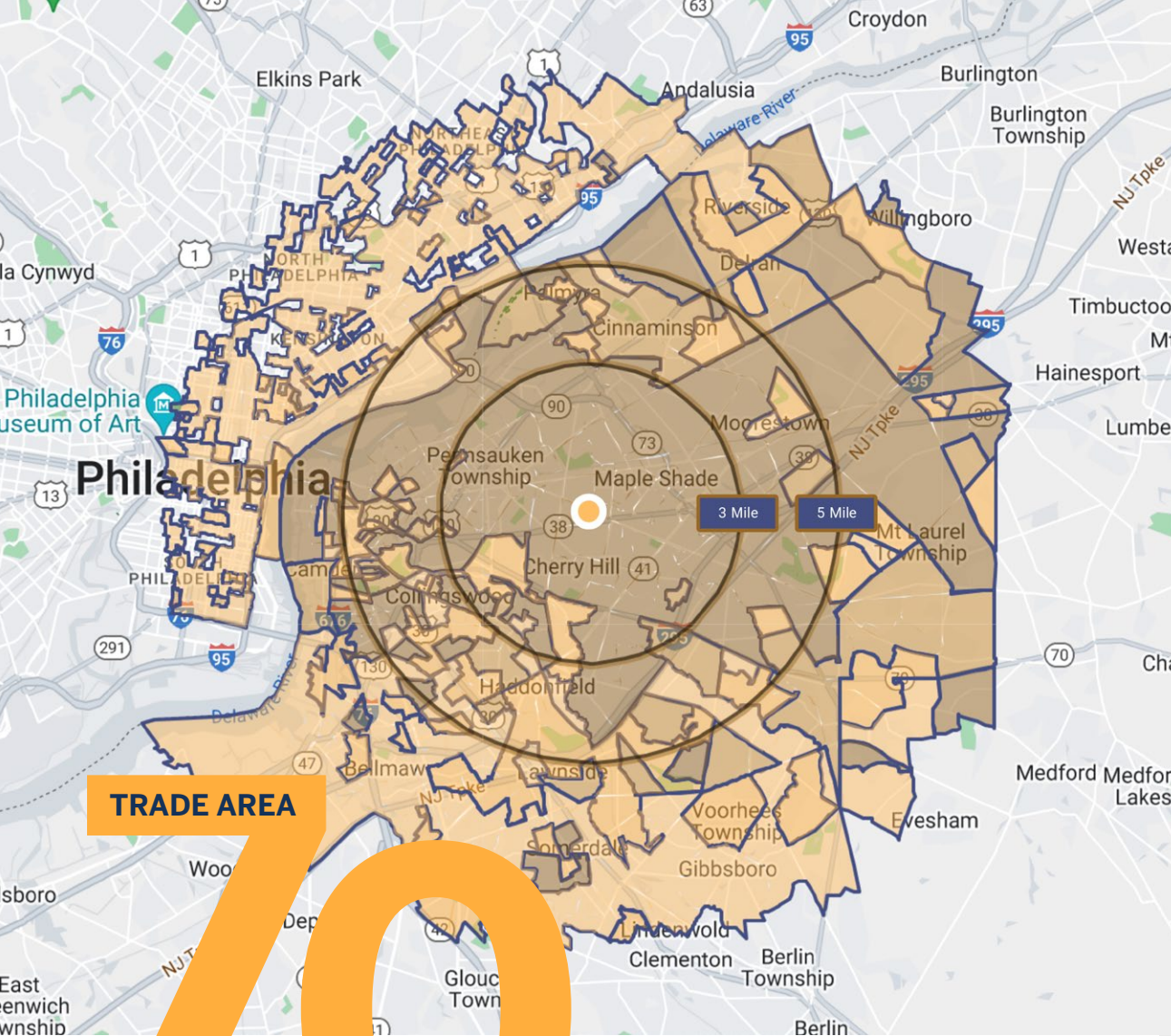

TRADE AREA

70%

DEMOGRAPHICS

Sources: ESRI and CreditnTell. CreditnTell's Tru Trade is based on geo-fenced data embedded in over 500 applications on tens of millions of mobile devices nationwide.

POPULATION

1,233,916	117,263	288,166
Tru Trade*	3 Mile	5 Mile

FAMILY HOUSEHOLDS

477,961	45,654	110,752
Tru Trade*	3 Mile	5 Mile

AVERAGE HH INCOME

\$78,406	\$117,951	\$122,790
Tru Trade*	3 Mile	5 Mile

COLLEGE EDUCATION

32%	39.1%	40.4%
Tru Trade*	3 Mile	5 Mile

*Tru Trade Area; 9 Miles

AERIAL



The area is home to top healthcare systems, including Cooper Health, Kennedy Health Systems, Penn Medicine, Virtua Health, and Our Lady of Lourdes Medical Center.

SITE PLAN - GROUND

Total SF	421,697
Parking Spaces	1,741
Parking Ratio	4.4 : 1,000 SF



SITE PLAN - 2ND FLOOR

TENANTS

C2 Raymour & Flanigan

SQFT

28,335

HIGHLIGHTS

Total SF 28,335

Parking Spaces 1,741

Parking Ratio 4.4 : 1,000 SF

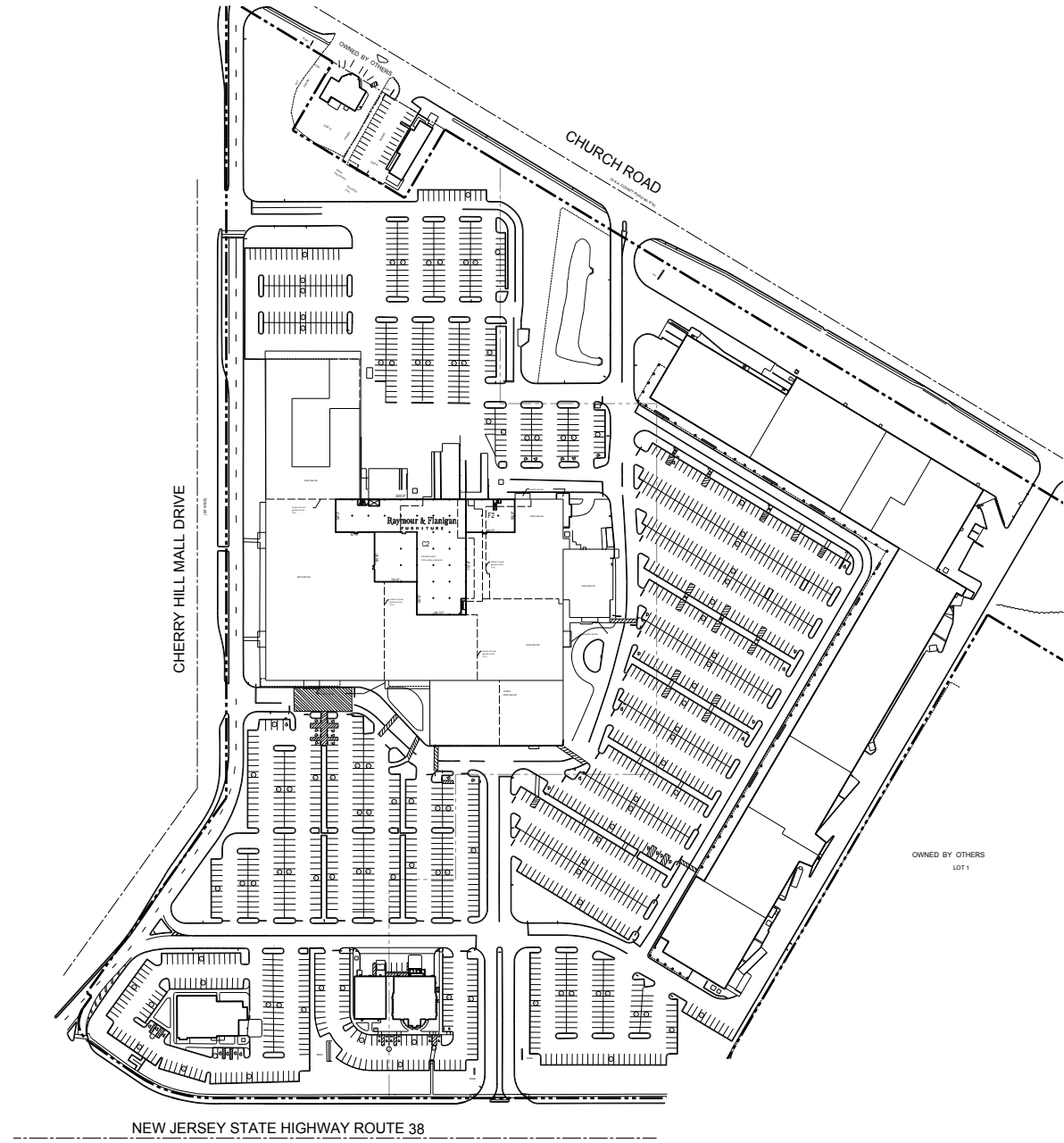



LEASING VIDEO



Leasing Agent
Justin Lustig
201.571.3515
jlustig@uedge.com



Leasing Agent
Scott Auster
201.571.3507
sauster@uedge.com



Specialty Leasing
Patricia Zafferese
201.882.7506
pzafferese@uedge.com



Corporate

New York

888 Seventh Avenue, 6th Floor
New York, New York, 10019
General Inquiries:
212.956.2556
Leasing: 844.614.4114

Management

New Jersey

210 Route 4 East
Paramus, New Jersey, 07652
General Inquiries: 201.571.3500
Leasing: 844.614.4114