

# Rockville Town Center

199 East Montgomery Avenue, Rockville, MD 20850



GLA: 98,410 SF

Acres: 1.51

Parking Spaces: 0/Ratio: 3.873:1,000 SF

County: Montgomery

## For Leasing Contact:

Joshua Birns

Tel: 212-956-2235

[jbirns@uedge.com](mailto:jbirns@uedge.com)

[UEDGE.COM](http://UEDGE.COM)

## Demographics: 3-Mile Radius



Population  
112,564



Households  
44,554



Daytime Pop.  
166,315



AHFI  
\$178,444



MHI  
\$119,343



College Ed.  
69.4%

Demographics data Provided by: ESRI



# Rockville Town Center

199 East Montgomery Avenue, Rockville, MD 20850



## Retail Spaces (SF)

Storage	Available	
1	Dream Land	1,852
2	Giuseppi's Pizza Plus	2,392
3	Potbelly Sandwich Works	2,699
4	Amai Crepe	725
5	Regal Cinema	3,940
6	Q.L. Barbershop	426
7	Ben & Jerry's	1,000
8	Chef Wang's Kitchen	2,885
9	Hot Pot City	2,815

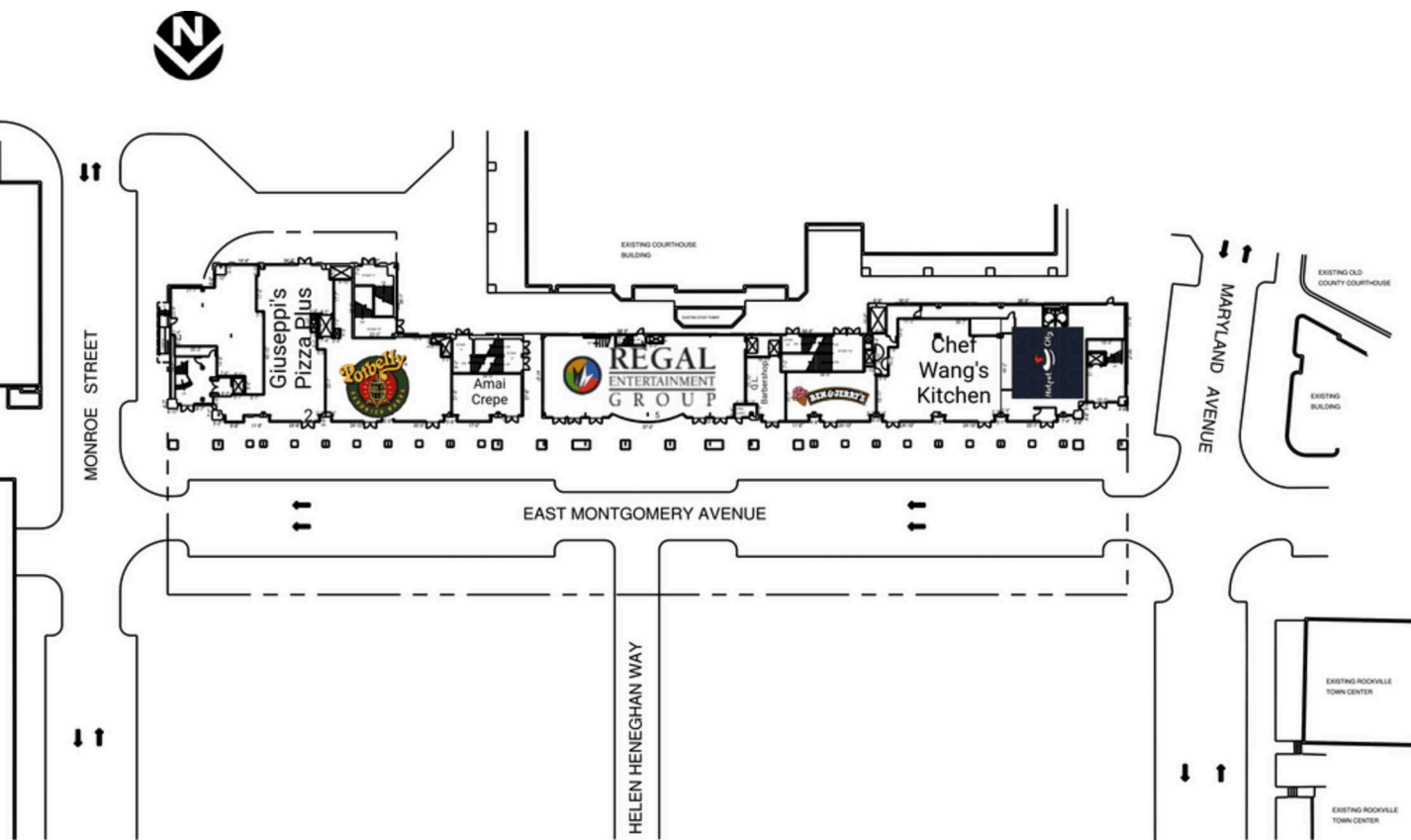

THIS EXHIBIT SHALL NOT BE DEEMED A WARRANTY, REPRESENTATION OR AGREEMENT BY LANDLORD THAT THE LAYOUT OR CONFIGURATION OF THE SHOPPING CENTER, OR ANY PART THEREOF, SHALL REMAIN AS SHOWN HEREON. LANDLORD RESERVES THE RIGHT TO MODIFY THE SHOPPING CENTER, OR ANY PART THEREOF, IN ACCORDANCE WITH THE PROVISIONS OF THE LEASE.

# Rockville Town Center

199 East Montgomery Avenue, Rockville, MD 20850



## Retail Spaces (SF)

11	Montgomery Cnty MD (Sheriff)	6,554
201	Regus Corporation	14,190

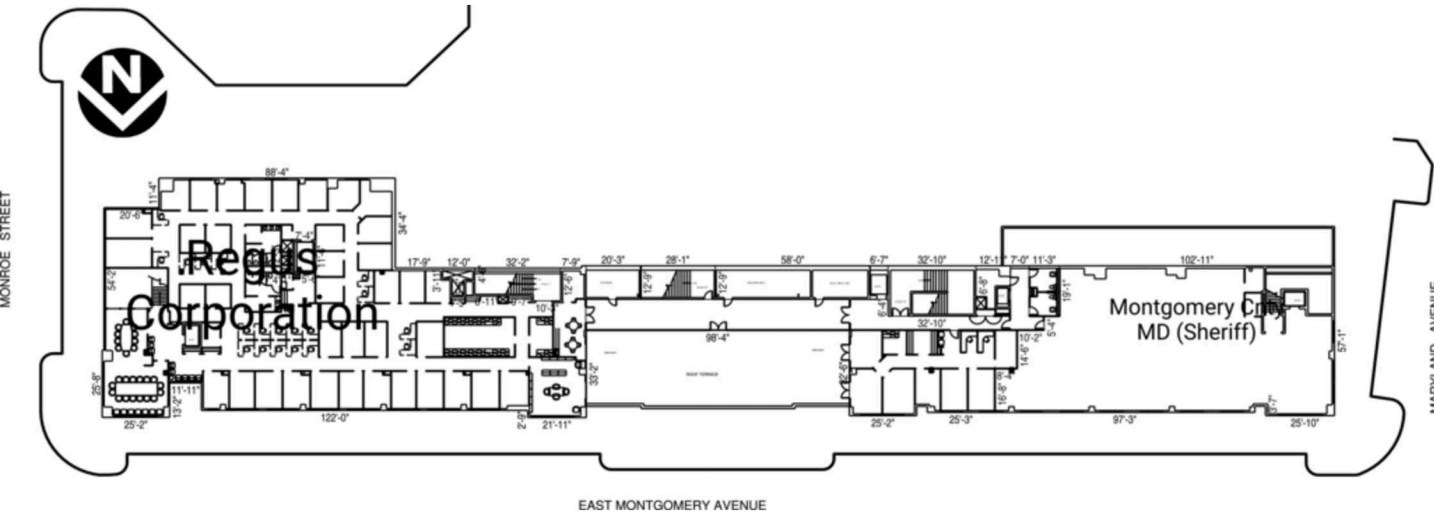

THIS EXHIBIT SHALL NOT BE DEEMED A WARRANTY, REPRESENTATION OR AGREEMENT BY LANDLORD THAT THE LAYOUT OR CONFIGURATION OF THE SHOPPING CENTER, OR ANY PART THEREOF, SHALL REMAIN AS SHOWN HEREON. LANDLORD RESERVES THE RIGHT TO MODIFY THE SHOPPING CENTER, OR ANY PART THEREOF, IN ACCORDANCE WITH THE PROVISIONS OF THE LEASE.

199 East Montgomery Avenue, Rockville, MD 20850



5a Regal Cinema 8,112

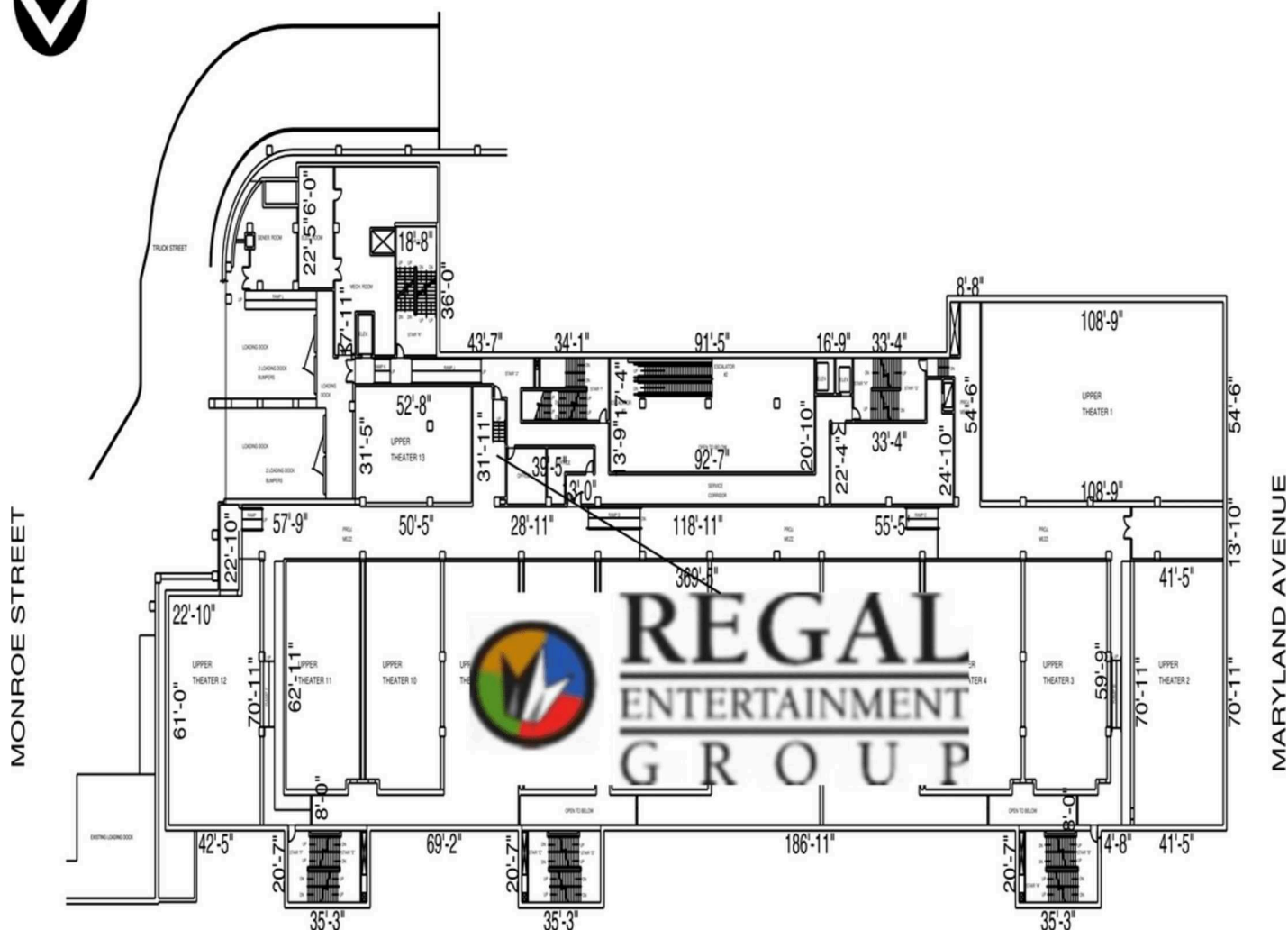

THIS EXHIBIT SHALL NOT BE DEEMED A WARRANTY, REPRESENTATION OR AGREEMENT BY LANDLORD THAT THE LAYOUT OR CONFIGURATION OF THE SHOPPING CENTER, OR ANY PART THEREOF, SHALL REMAIN AS SHOWN HEREON. LANDLORD RESERVES THE RIGHT TO MODIFY THE SHOPPING CENTER, OR ANY PART THEREOF, IN ACCORDANCE WITH THE PROVISIONS OF THE LEASE.

# Rockville Town Center

199 East Montgomery Avenue, Rockville, MD 20850



## Retail Spaces (SF)

5b Regal Cinema 50,584

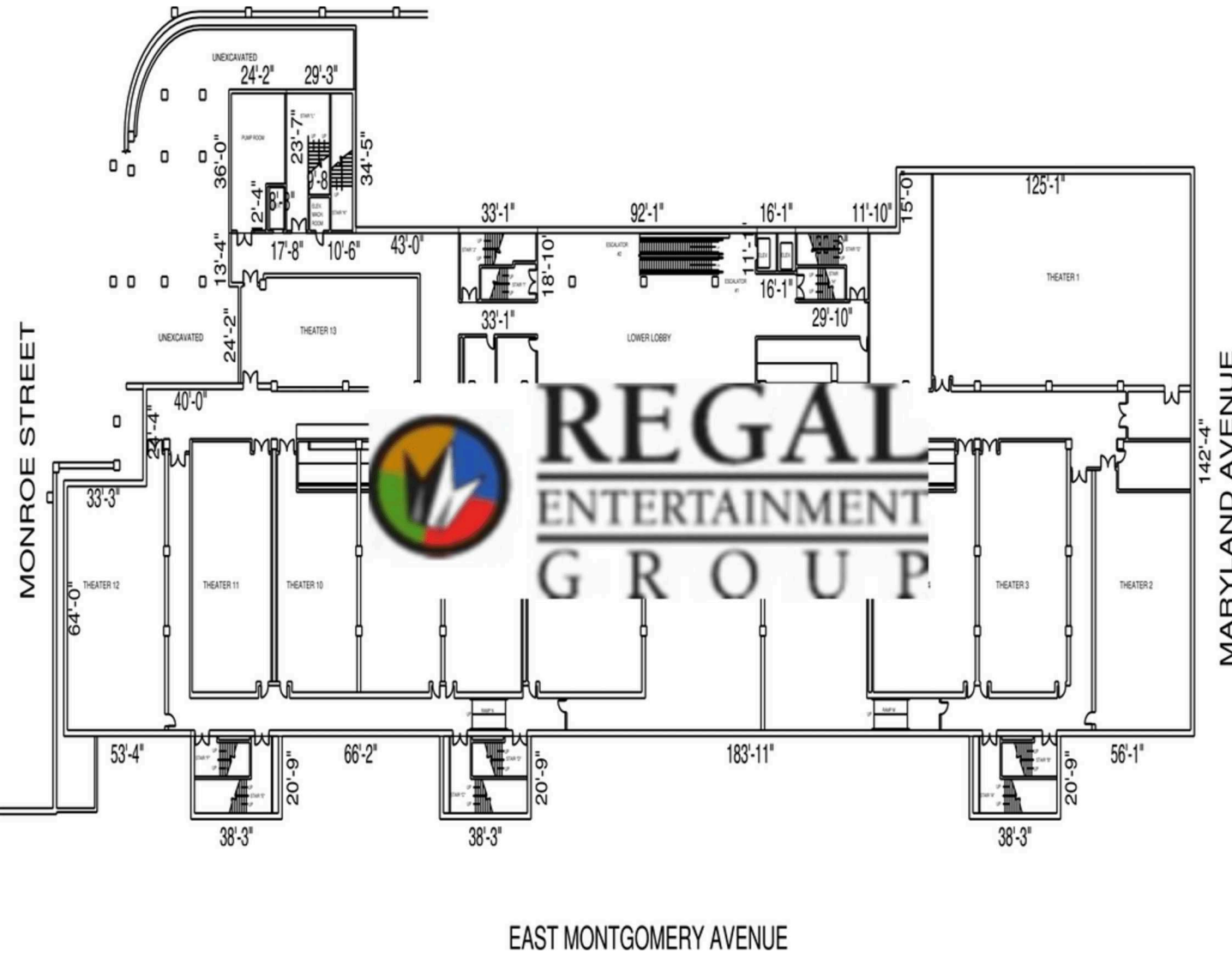

THIS EXHIBIT SHALL NOT BE DEEMED A WARRANTY, REPRESENTATION OR AGREEMENT BY LANDLORD THAT THE LAYOUT OR CONFIGURATION OF THE SHOPPING CENTER, OR ANY PART THEREOF, SHALL REMAIN AS SHOWN HEREON. LANDLORD RESERVES THE RIGHT TO MODIFY THE SHOPPING CENTER, OR ANY PART THEREOF, IN ACCORDANCE WITH THE PROVISIONS OF THE LEASE.