

Yonkers Gateway Center

2500 Central Park Avenue, Yonkers, NY 10710



GLA: 439,366 SF

Acres: 10.46

Parking Spaces: 1,647/Ratio: 3.68:1,000 SF

County: Westchester

For Leasing Contact:

Joshua Birns

Tel: 212-956-2235

jbirns@uedge.com

UEDGE.COM

Demographics: 3-Mile Radius



Population
126,958



Households
48,002



Daytime Pop.
115,348



AHHI
\$222,489



MHHI
\$149,014



College Ed.
66.6%

Demographics data Provided by: ESRI

Yonkers Gateway Center

2500 Central Park Avenue, Yonkers, NY 10710

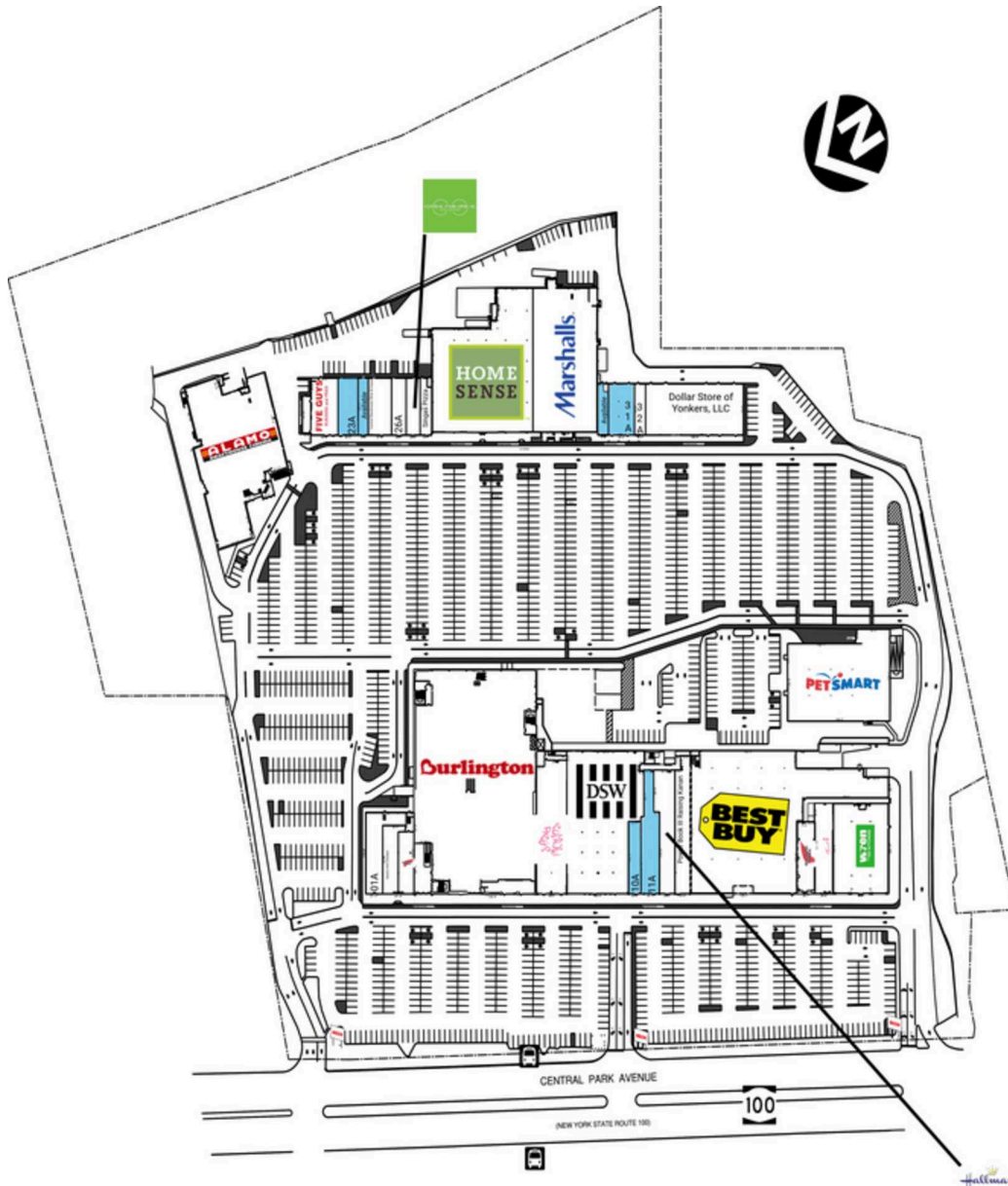

Retail Spaces (SF)

| | | |
|------|---------------------------------|--------|
| 01A | Power Book III Raising Kanan | 3,500 |
| 2A-1 | Dave's Hot Chicken | 2,482 |
| 2A-2 | Red Wing Shoes | 2,217 |
| 03A | Burlington | 70,807 |
| 10A | Available | 2,008 |
| 11A | Available | 4,300 |
| 12A | Hallmark | 4,833 |
| 13A | Power Book III Raising Kanan | 4,712 |
| 14A | Best Buy | 40,197 |
| 18A | Red Wing Shoes | 2,664 |
| 19A | Torrid | 3,750 |
| 19B | Wren Kitchens | 11,288 |
| 20A | PetSmart | 19,056 |
| 21A | Alamo Drafthouse Cinema | 21,324 |
| 22A | Five Guys Burgers and Fries | 4,044 |
| 23A | Available | 2,600 |
| 24A | Available | 1,300 |
| 25A | Central Warehouse Wine & Liquor | 3,000 |
| 26A | Steve's Shoes | 2,000 |
| 27A | Central Park Optical | 1,800 |
| 28A | Singas Pizza | 1,360 |
| 29A | Marshalls | 20,856 |
| 29B | Home Sense | 27,128 |
| 30A | Available | 1,214 |

THIS EXHIBIT SHALL NOT BE DEEMED A WARRANTY, REPRESENTATION OR AGREEMENT BY LANDLORD THAT THE LAYOUT OR CONFIGURATION OF THE SHOPPING CENTER, OR ANY PART THEREOF, SHALL REMAIN AS SHOWN HEREON. LANDLORD RESERVES THE RIGHT TO MODIFY THE SHOPPING CENTER, OR ANY PART THEREOF, IN ACCORDANCE WITH THE PROVISIONS OF THE LEASE.

Yonkers Gateway Center

2500 Central Park Avenue, Yonkers, NY 10710



Retail Spaces (SF)

03C Burlington 72,180

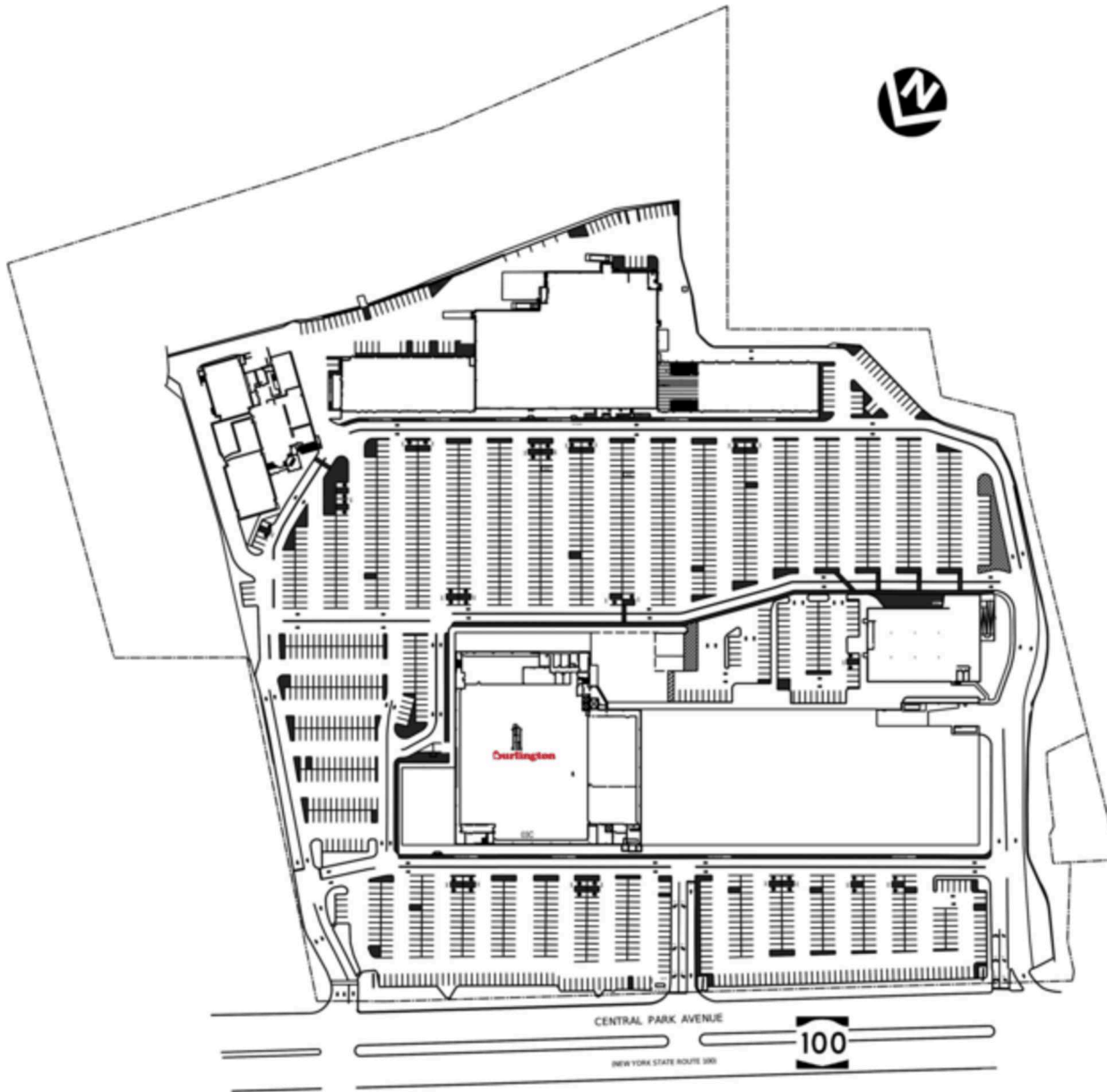

THIS EXHIBIT SHALL NOT BE DEEMED A WARRANTY, REPRESENTATION OR AGREEMENT BY LANDLORD THAT THE LAYOUT OR CONFIGURATION OF THE SHOPPING CENTER, OR ANY PART THEREOF, SHALL REMAIN AS SHOWN HEREON. LANDLORD RESERVES THE RIGHT TO MODIFY THE SHOPPING CENTER, OR ANY PART THEREOF, IN ACCORDANCE WITH THE PROVISIONS OF THE LEASE.

Yonkers Gateway Center

2500 Central Park Avenue, Yonkers, NY 10710

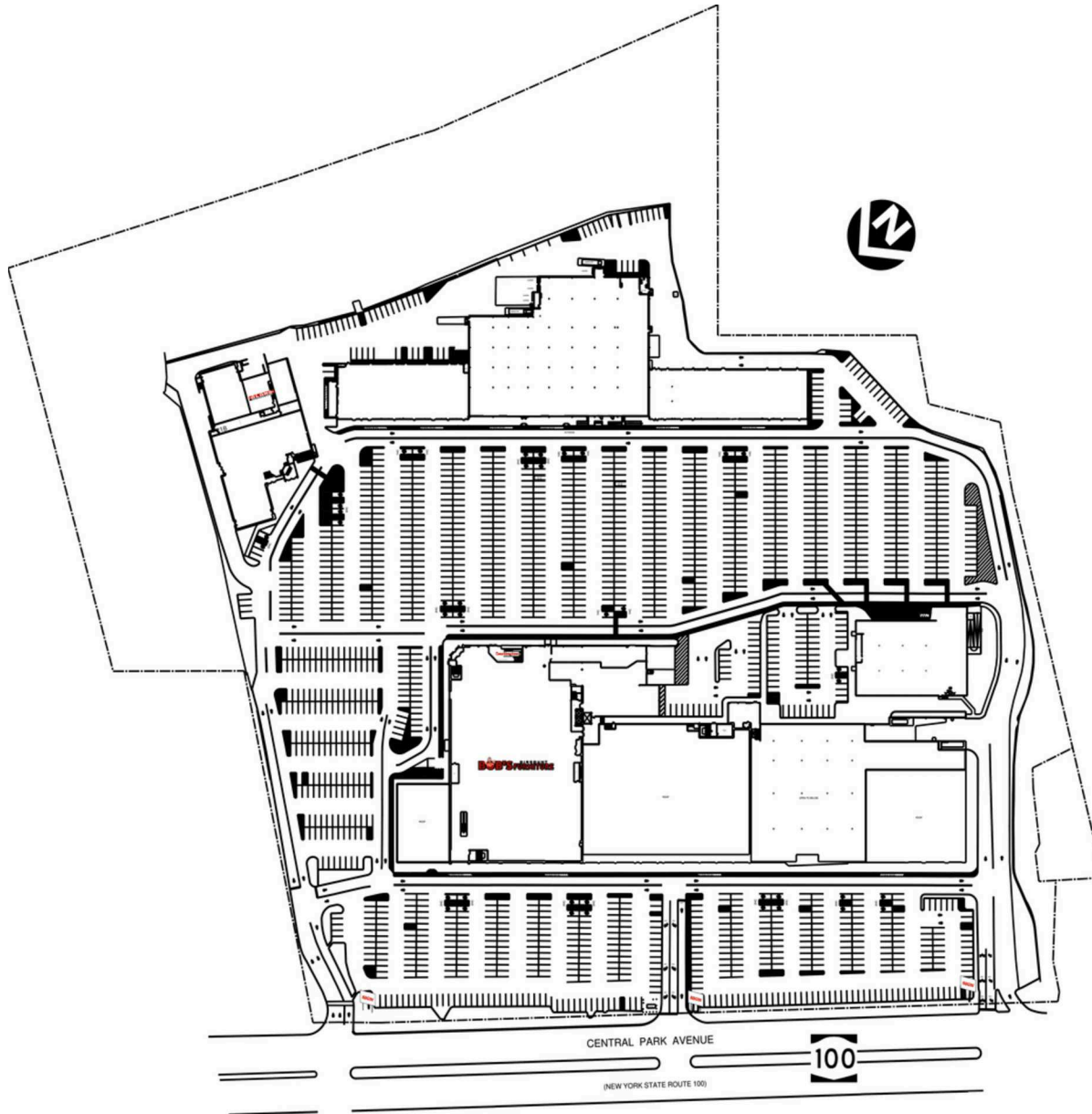

Retail Spaces (SF)

| | | |
|-----|----------------------------|--------|
| 03B | Bobs Furniture | 62,930 |
| 03D | Burlington | 1,083 |
| 14B | Best Buy | 2,029 |
| 21B | Alamo Drafthouse Cinema | 4,272 |

THIS EXHIBIT SHALL NOT BE DEEMED A WARRANTY, REPRESENTATION OR AGREEMENT BY LANDLORD THAT THE LAYOUT OR CONFIGURATION OF THE SHOPPING CENTER, OR ANY PART THEREOF, SHALL REMAIN AS SHOWN HEREON. LANDLORD RESERVES THE RIGHT TO MODIFY THE SHOPPING CENTER, OR ANY PART THEREOF, IN ACCORDANCE WITH THE PROVISIONS OF THE LEASE.