

Yonkers Gateway Center

2500 Central Park Avenue, Yonkers, NY 10710



GLA: 439,366 SF

Acres: 10.46

Parking Spaces: 1,647/Ratio: 3.68:1,000 SF

County: Westchester

For Leasing Contact:

Joshua Birns

Tel: 212-956-2235

jbirns@uedge.com

UEDGE.COM

Demographics: 3-Mile Radius



Population
126,958



Households
48,002



Daytime Pop.
115,348



AHHI
\$222,489



MHHI
\$149,014



College Ed.
66.6%

Demographics data Provided by: ESRI

Yonkers Gateway Center

2500 Central Park Avenue, Yonkers, NY 10710

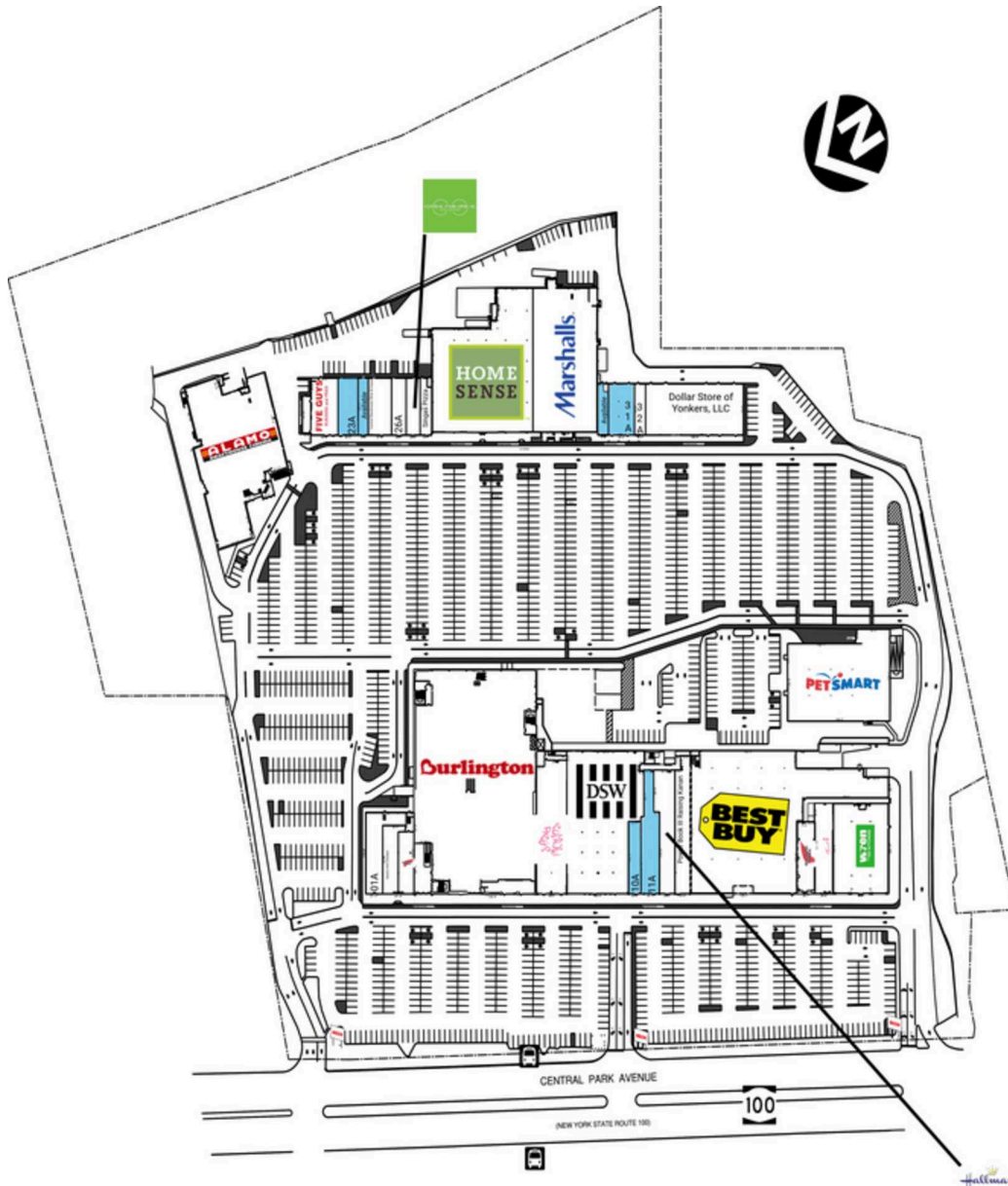

Retail Spaces (SF)

01A	Power Book III Raising Kanan	3,500
2A-1	Dave's Hot Chicken	2,482
2A-2	Red Wing Shoes	2,217
03A	Burlington	70,807
10A	Available	2,008
11A	Available	4,300
12A	Hallmark	4,833
13A	Power Book III Raising Kanan	4,712
14A	Best Buy	40,197
18A	Red Wing Shoes	2,664
19A	Torrid	3,750
19B	Wren Kitchens	11,288
20A	PetSmart	19,056
21A	Alamo Drafthouse Cinema	21,324
22A	Five Guys Burgers and Fries	4,044
23A	Available	2,600
24A	Available	1,300
25A	Central Warehouse Wine & Liquor	3,000
26A	Steve's Shoes	2,000
27A	Central Park Optical	1,800
28A	Singas Pizza	1,360
29A	Marshalls	20,856
29B	Home Sense	27,128
30A	Available	1,214

THIS EXHIBIT SHALL NOT BE DEEMED A WARRANTY, REPRESENTATION OR AGREEMENT BY LANDLORD THAT THE LAYOUT OR CONFIGURATION OF THE SHOPPING CENTER, OR ANY PART THEREOF, SHALL REMAIN AS SHOWN HEREON. LANDLORD RESERVES THE RIGHT TO MODIFY THE SHOPPING CENTER, OR ANY PART THEREOF, IN ACCORDANCE WITH THE PROVISIONS OF THE LEASE.

Yonkers Gateway Center

2500 Central Park Avenue, Yonkers, NY 10710



Retail Spaces (SF)

03C Burlington 72,180

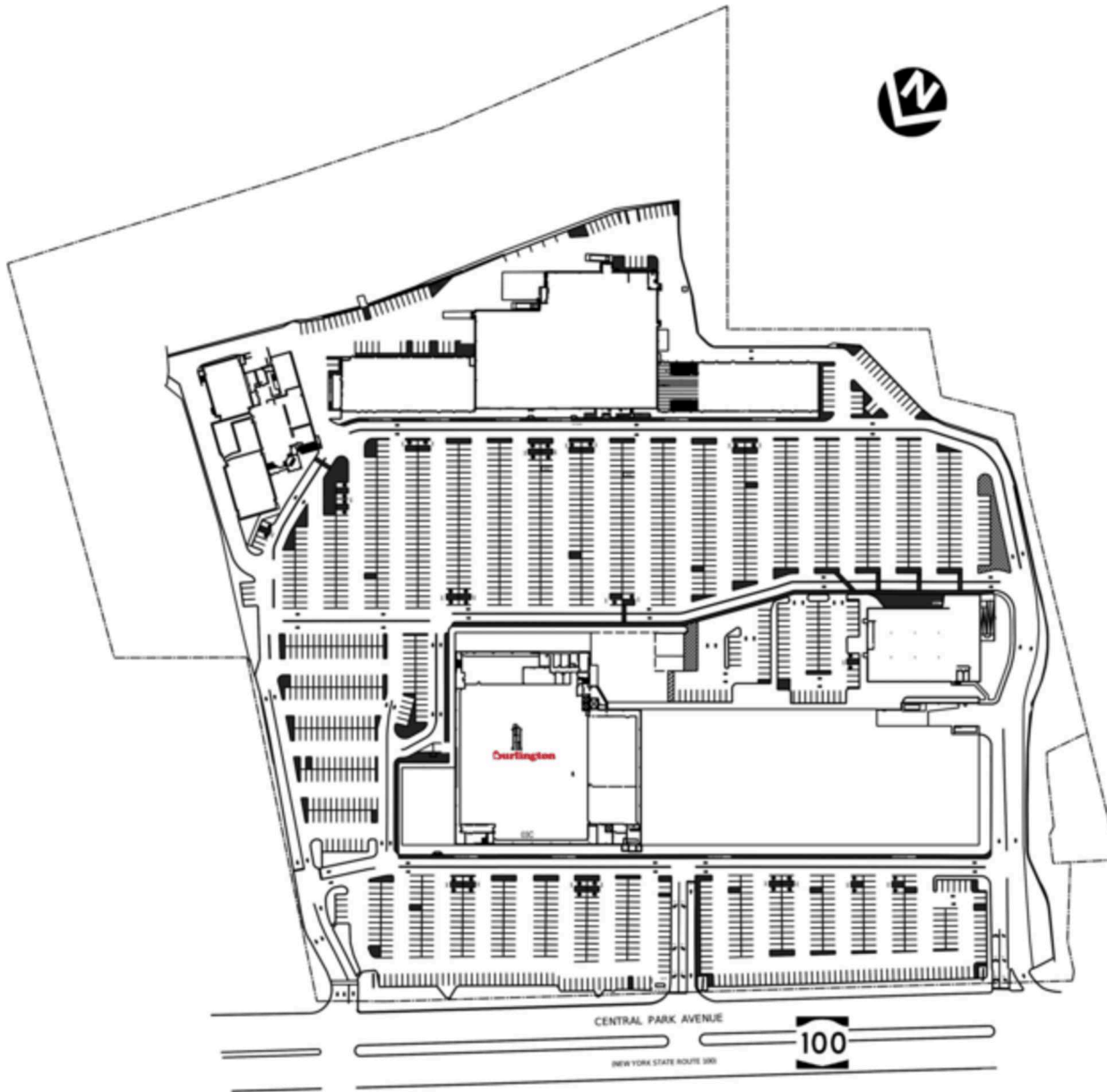

THIS EXHIBIT SHALL NOT BE DEEMED A WARRANTY, REPRESENTATION OR AGREEMENT BY LANDLORD THAT THE LAYOUT OR CONFIGURATION OF THE SHOPPING CENTER, OR ANY PART THEREOF, SHALL REMAIN AS SHOWN HEREON. LANDLORD RESERVES THE RIGHT TO MODIFY THE SHOPPING CENTER, OR ANY PART THEREOF, IN ACCORDANCE WITH THE PROVISIONS OF THE LEASE.

Yonkers Gateway Center

2500 Central Park Avenue, Yonkers, NY 10710

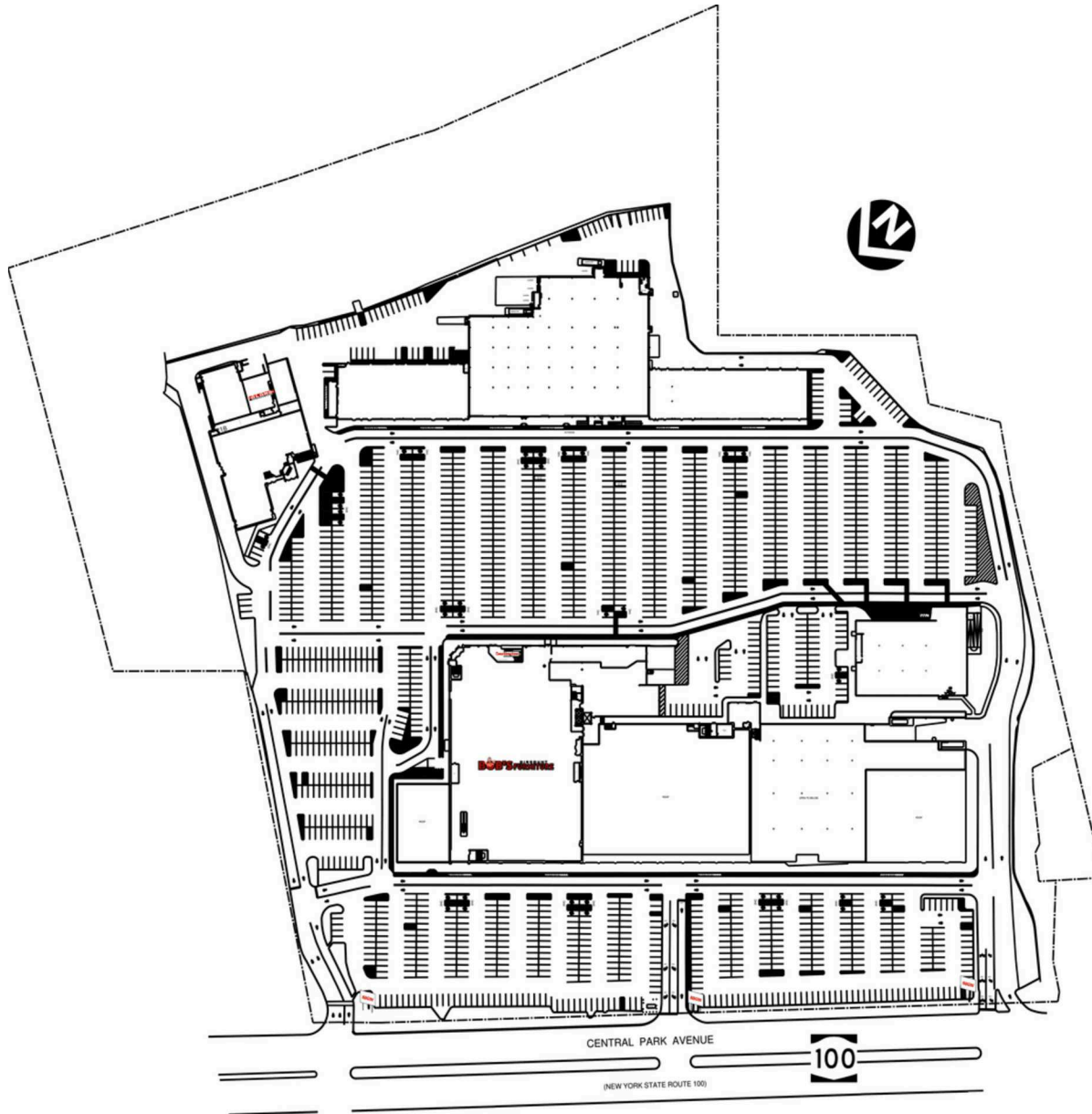

Retail Spaces (SF)

03B	Bobs Furniture	62,930
03D	Burlington	1,083
14B	Best Buy	2,029
21B	Alamo Drafthouse Cinema	4,272

THIS EXHIBIT SHALL NOT BE DEEMED A WARRANTY, REPRESENTATION OR AGREEMENT BY LANDLORD THAT THE LAYOUT OR CONFIGURATION OF THE SHOPPING CENTER, OR ANY PART THEREOF, SHALL REMAIN AS SHOWN HEREON. LANDLORD RESERVES THE RIGHT TO MODIFY THE SHOPPING CENTER, OR ANY PART THEREOF, IN ACCORDANCE WITH THE PROVISIONS OF THE LEASE.