

# The Plaza at Woodbridge

675 Route 1, Woodbridge, NJ 08830



GLA: 410,788 SF

Acres: 28.66

Parking Spaces: 1,996/Ratio: 4.99:1,000 SF

County: Middlesex

## For Leasing Contact:

Justin Lustig  
Tel: 201-571-3515  
jlustig@uedge.com  
UEDGE.COM

## Demographics: 3-Mile Radius

  
Population  
147,400

  
Households  
52,450

  
Daytime Pop.  
145,164

  
AHHI  
\$133,752

  
MHHI  
\$102,219

  
College Ed.  
44.8%

Demographics data Provided by: ESRI



# The Plaza at Woodbridge

675 Route 1, Woodbridge, NJ 08830

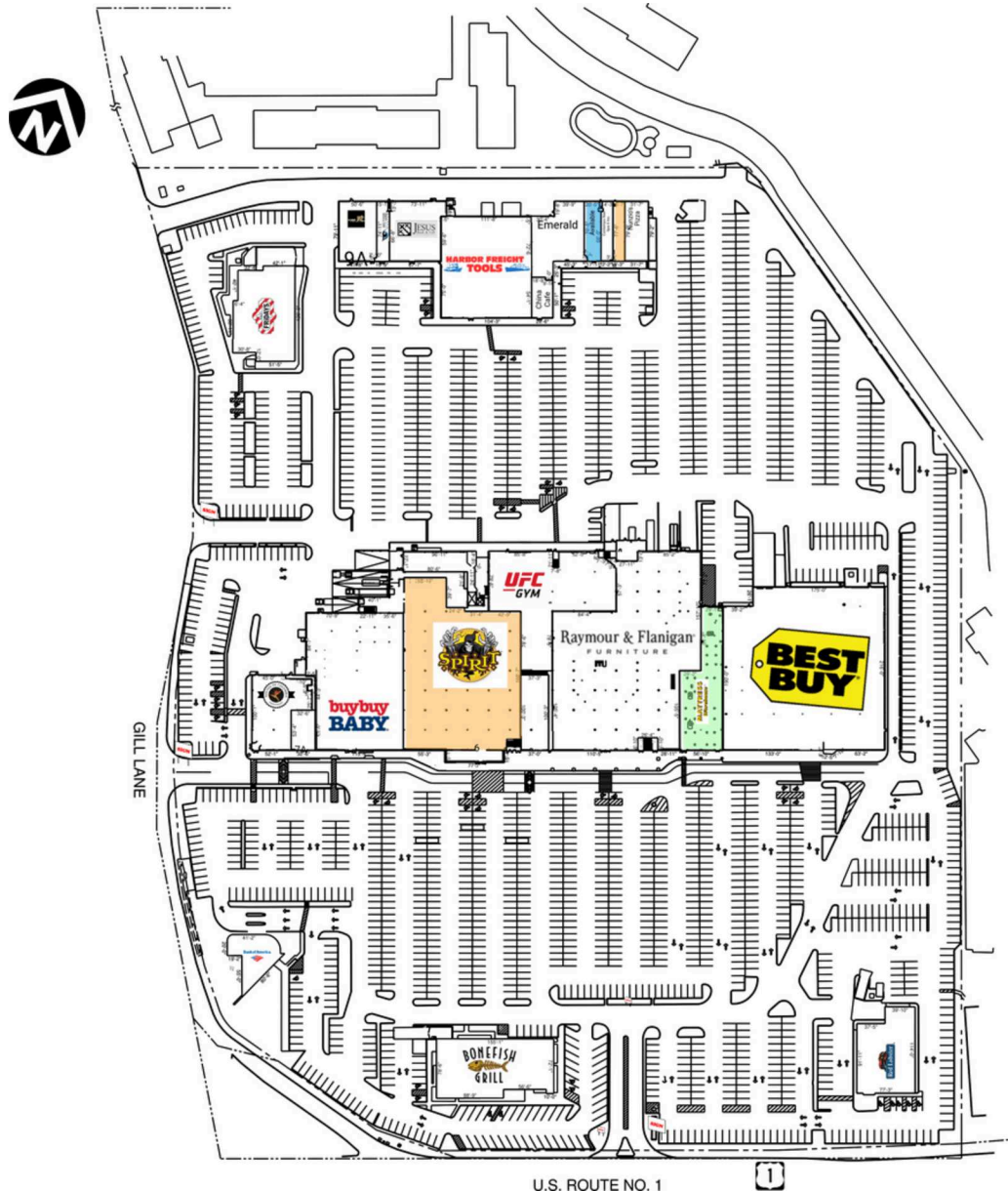

## Retail Spaces (SF)

F1	Red Lobster	7,865
F2	Bonefish Grill	10,500
F3	Bank of America	4,000
F4	T.G.I Friday's	8,500
1A	Best Buy	45,400
2A	Mattress Warehouse	5,906
3A	Raymour & Flanigan	40,955
4A	UFC Gym	16,810
6	Spirit Halloween	34,000
6A	Buy Buy Baby	21,794
7A	Karate USA	1,946
8A	Noches De Colombia	6,287
9A	U-Yee Sushi	4,040
10B	Meltzer Eye Care	1,360
11A	Jesus Book & Gift	5,400
12A	Harbor Freight Tools	16,265
13A	China Cafe	1,560
13B	Emerald	5,752
15A	Available	1,700
16A	Contempo Nail Spa II Inc.	1,240
16B	Vineeta's Beauty Salon	1,240
17A	Nunzio's Pizza	2,520
20	Extra Space Storage	2,914

THIS EXHIBIT SHALL NOT BE DEEMED A WARRANTY, REPRESENTATION OR AGREEMENT BY LANDLORD THAT THE LAYOUT OR CONFIGURATION OF THE SHOPPING CENTER, OR ANY PART THEREOF, SHALL REMAIN AS SHOWN HEREON. LANDLORD RESERVES THE RIGHT TO MODIFY THE SHOPPING CENTER, OR ANY PART THEREOF, IN ACCORDANCE WITH THE PROVISIONS OF THE LEASE.

# The Plaza at Woodbridge

675 Route 1, Woodbridge, NJ 08830

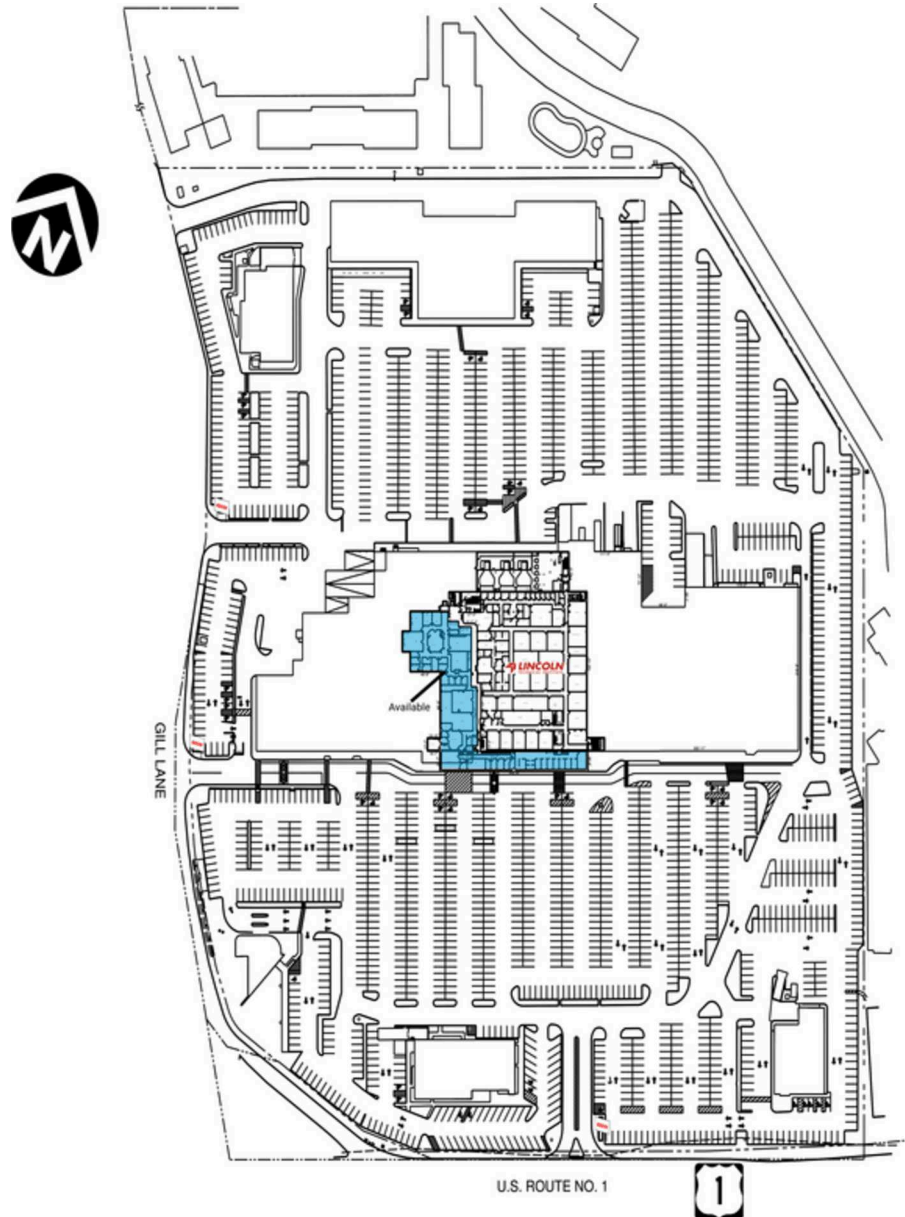

## Retail Spaces (SF)

AA	Available	19,317
BB	Lincoln Tech	31,500

THIS EXHIBIT SHALL NOT BE DEEMED A WARRANTY, REPRESENTATION OR AGREEMENT BY LANDLORD THAT THE LAYOUT OR CONFIGURATION OF THE SHOPPING CENTER, OR ANY PART THEREOF, SHALL REMAIN AS SHOWN HEREON. LANDLORD RESERVES THE RIGHT TO MODIFY THE SHOPPING CENTER, OR ANY PART THEREOF, IN ACCORDANCE WITH THE PROVISIONS OF THE LEASE.

# The Plaza at Woodbridge

675 Route 1, Woodbridge, NJ 08830

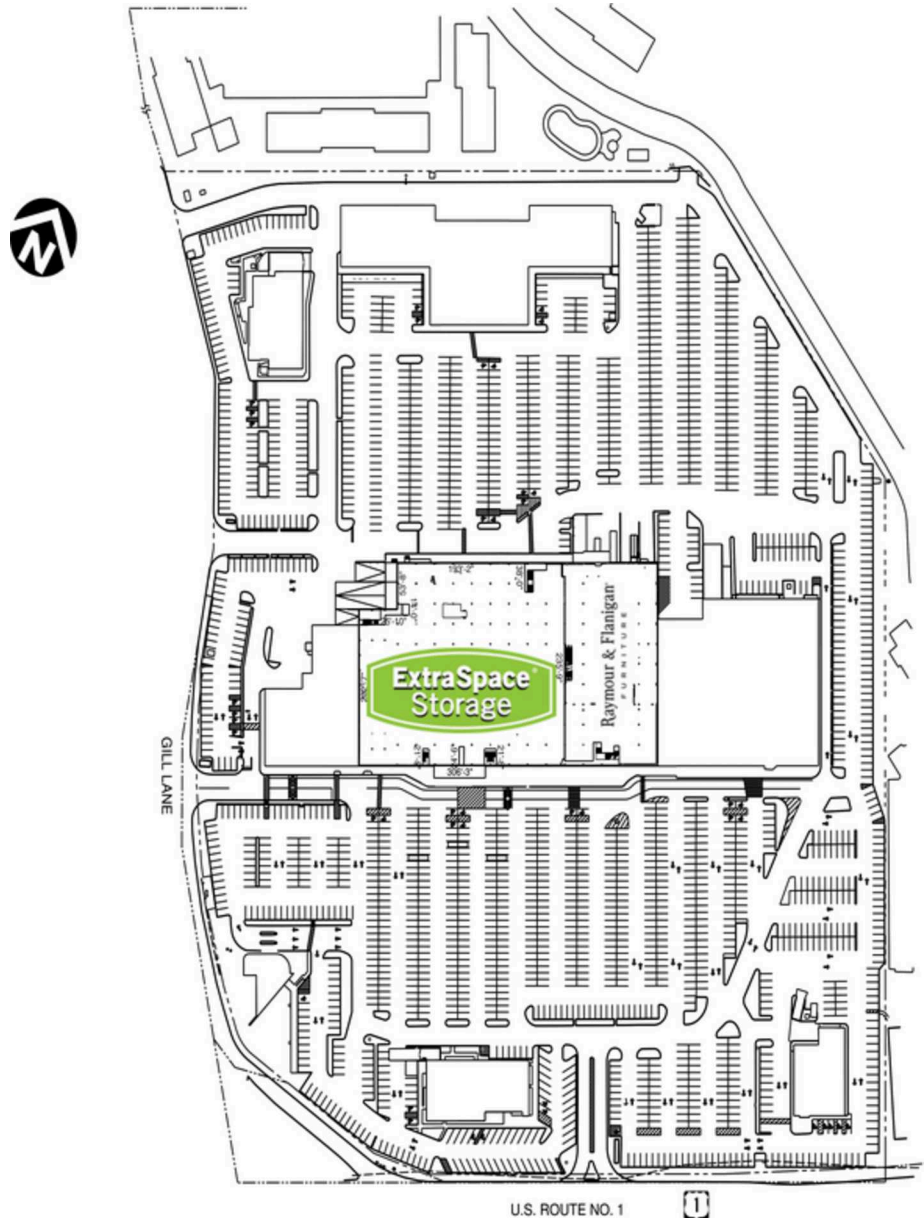

## Retail Spaces (SF)

3B	Raymour & Flanigan	35,084
5B	Extra Space Storage	61,551
6B	Extra Space Storage	15,382

THIS EXHIBIT SHALL NOT BE DEEMED A WARRANTY, REPRESENTATION OR AGREEMENT BY LANDLORD THAT THE LAYOUT OR CONFIGURATION OF THE SHOPPING CENTER, OR ANY PART THEREOF, SHALL REMAIN AS SHOWN HEREON. LANDLORD RESERVES THE RIGHT TO MODIFY THE SHOPPING CENTER, OR ANY PART THEREOF, IN ACCORDANCE WITH THE PROVISIONS OF THE LEASE.