

# Lodi Commons

4 Memorial Drive, Lodi, NJ 07644

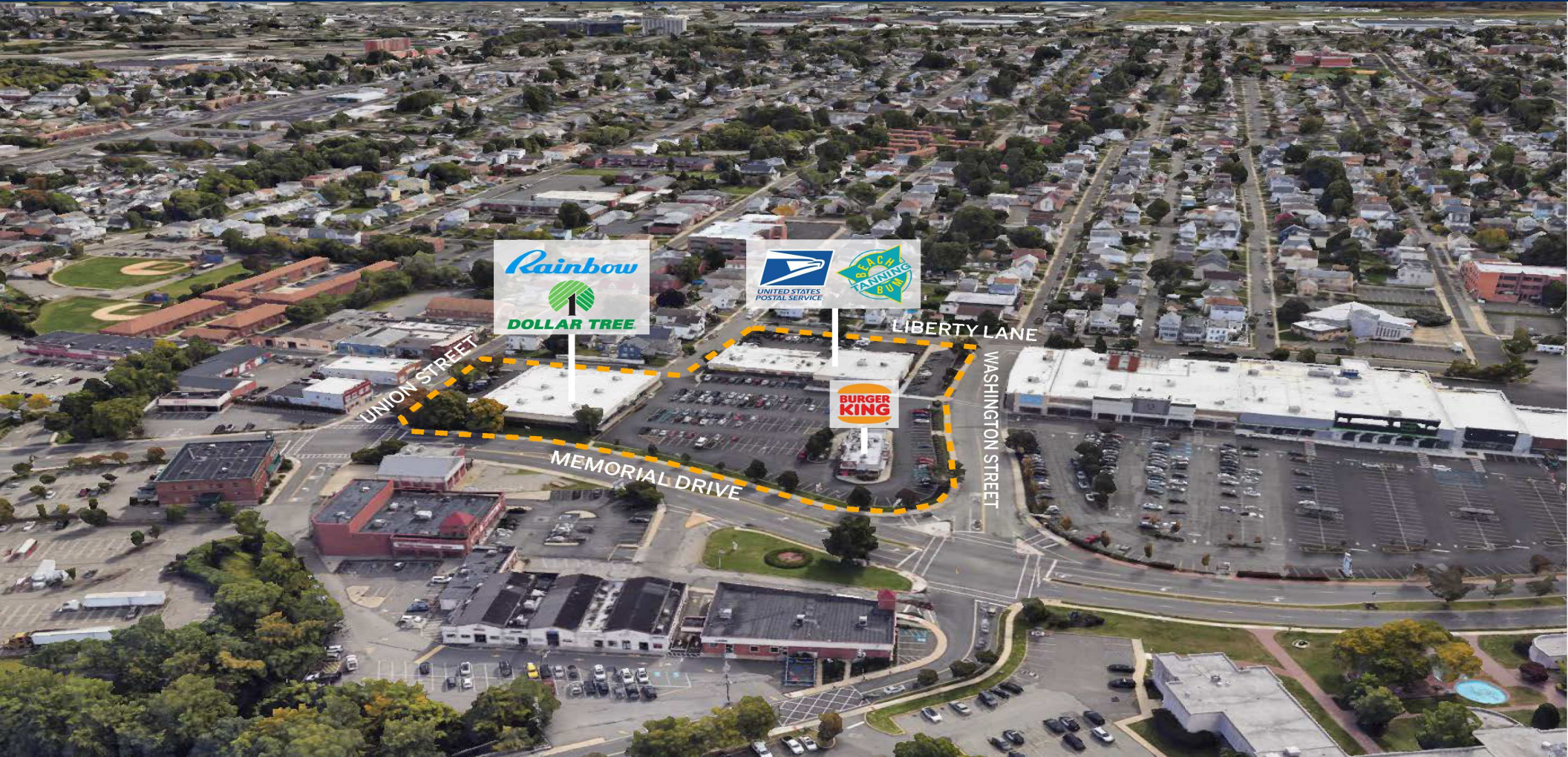

GLA: 42,752 SF

Acres: 7.19

Parking Spaces: 232/Ratio: SF

County: Bergen

## For Leasing Contact:

Gabby Semet

Tel: 2015713429

gsemet@uedge.com

UEDGE.COM

## Demographics: 3-Mile Radius



Population  
288,958



Households  
105,453



Daytime Pop.  
275,081



AHFI  
\$103,721



MHI  
\$74,576



College Ed.  
32.1%

Demographics data Provided by: ESRI



# Lodi Commons

4 Memorial Drive, Lodi, NJ 07644



## Retail Spaces (SF)

2	US Post Office	7,500
3	Chinatown Gourmet	1,426
4	Napoli Pizza	1,600
5	Lodi Liquors	1,686
6	Nail Perfection N Spa	1,710
7	Beach Bum Tan	3,424
8	Dollar Tree	12,740
9	Rainbow	3,640
10	Aaron's	6,026
11	Burger King	3,000

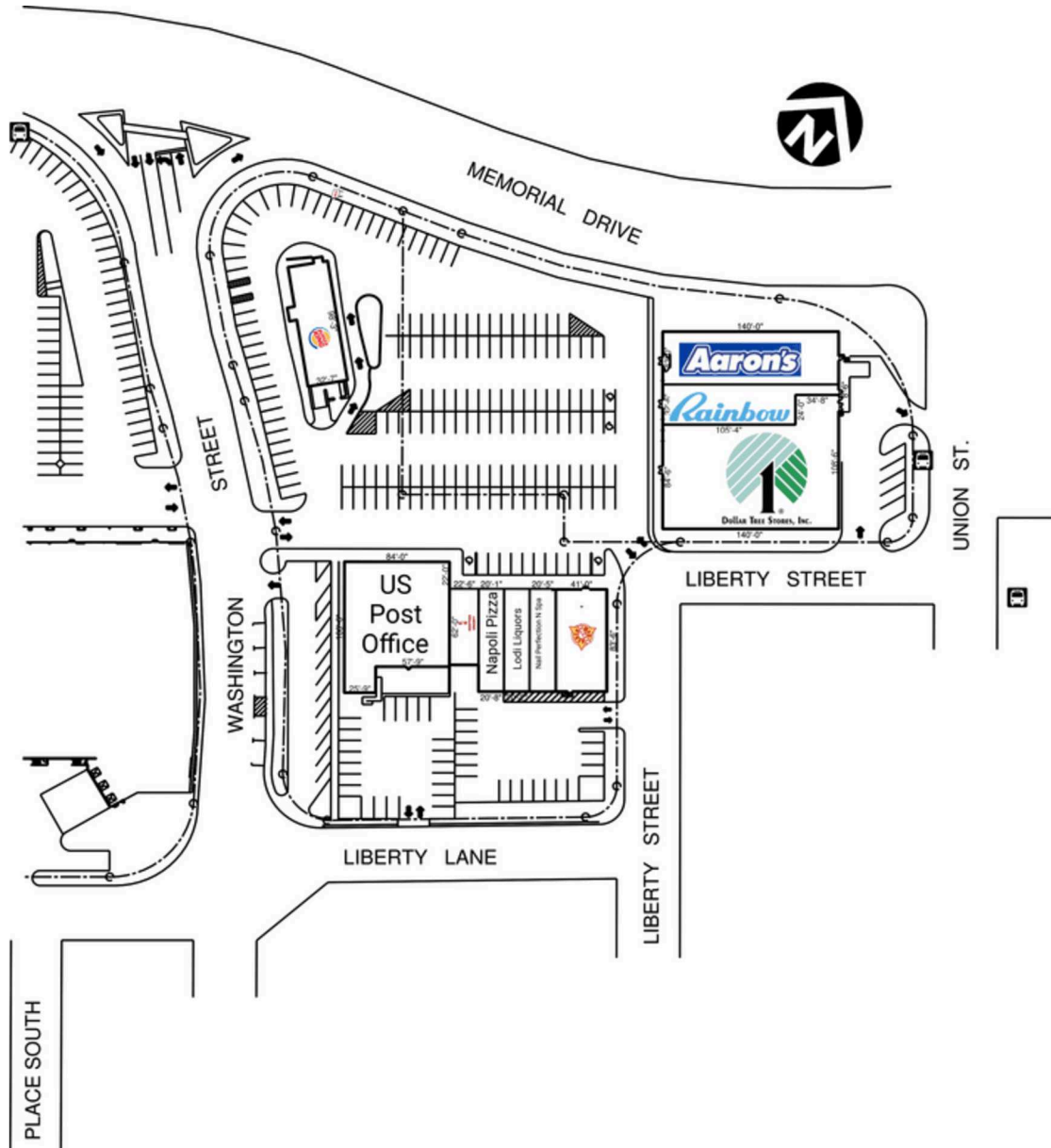

THIS EXHIBIT SHALL NOT BE DEEMED A WARRANTY, REPRESENTATION OR AGREEMENT BY LANDLORD THAT THE LAYOUT OR CONFIGURATION OF THE SHOPPING CENTER, OR ANY PART THEREOF, SHALL REMAIN AS SHOWN HEREON. LANDLORD RESERVES THE RIGHT TO MODIFY THE SHOPPING CENTER, OR ANY PART THEREOF, IN ACCORDANCE WITH THE PROVISIONS OF THE LEASE.